

General Requirements:

- The minimum paper size is 18" x 24".
- Plans must be complete, legible, accurate and drawn to scale.
- Provide three (3) sets of plans with each submittal.
- Address and owner information must be on plans.
- Signatures on the site plan from all neighbors where walls/fences are being constructed on or within 5' of property lines. When signatures cannot be obtained, a stamped and signed property survey by a licensed surveyor can be used in lieu of the signature; the surveyor will need to perform a final inspection/certification PRIOR to final inspection from Building and Safety. Walls cannot be reconstructed or newly constructed on property lines.
- Include complete scope of work.
- Include all property lines, existing structures, and driveways.
- Location of proposed wall, including length and height, and distance from existing structures.
- No writing/drawing in lower right corner.

PLOT PLAN FOR ILLUSTRATION ONLY

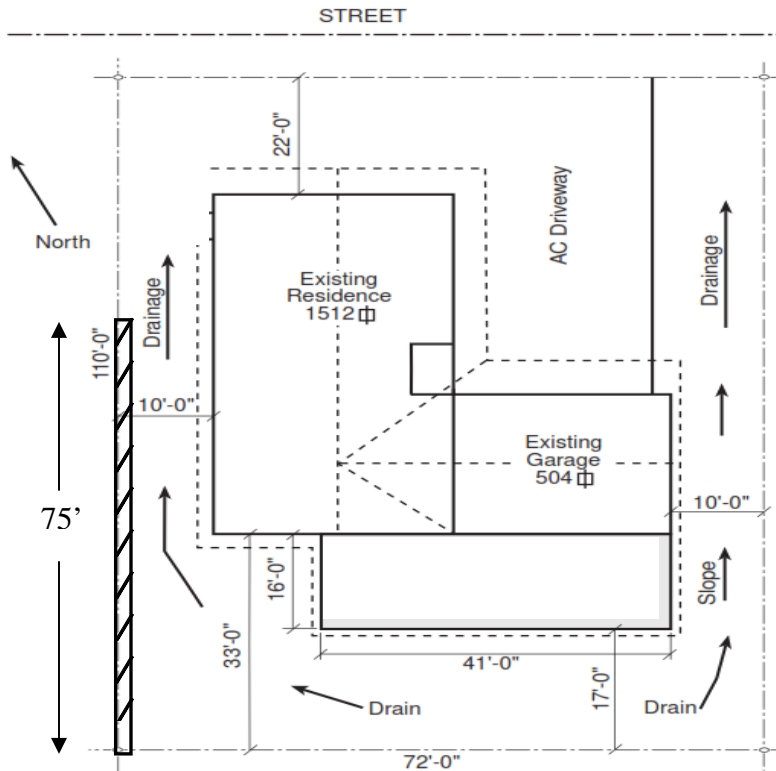

Scope of work:

I approve the wall construction location as indicated on this site plan.

Print Name and address _____

Sign _____

Leave this area clear on site plan.

BLOCK WALL STANDARD

MUST BE BUILT EXACTLY TO THESE SPECIFICATIONS

Specifications:

1. Footings should be level, or if ground slopes, use step footings. Each step should be of a height to fit masonry system. All excavations shall be extended into firm soil and shall be clean and contain no loose earth or foreign matter.
2. Minimum soil bearing to be 1000 psf.
3. For footings and foundations, use concrete with a minimum strength of 2500 psi @ 28 days
4. Grout ASTM C476
5. Mortar mix: Type S $f'_m=1500$ psi
6. Lap vertical steel 40 bar diameters. (24" minimum) $f_s=20,000$ psi
7. Concrete masonry units: ASTM C90 Concrete Block, Grade A
8. 4 ft max. lift subject to building inspector verification
9. Walls cannot be reconstructed or newly constructed on property lines

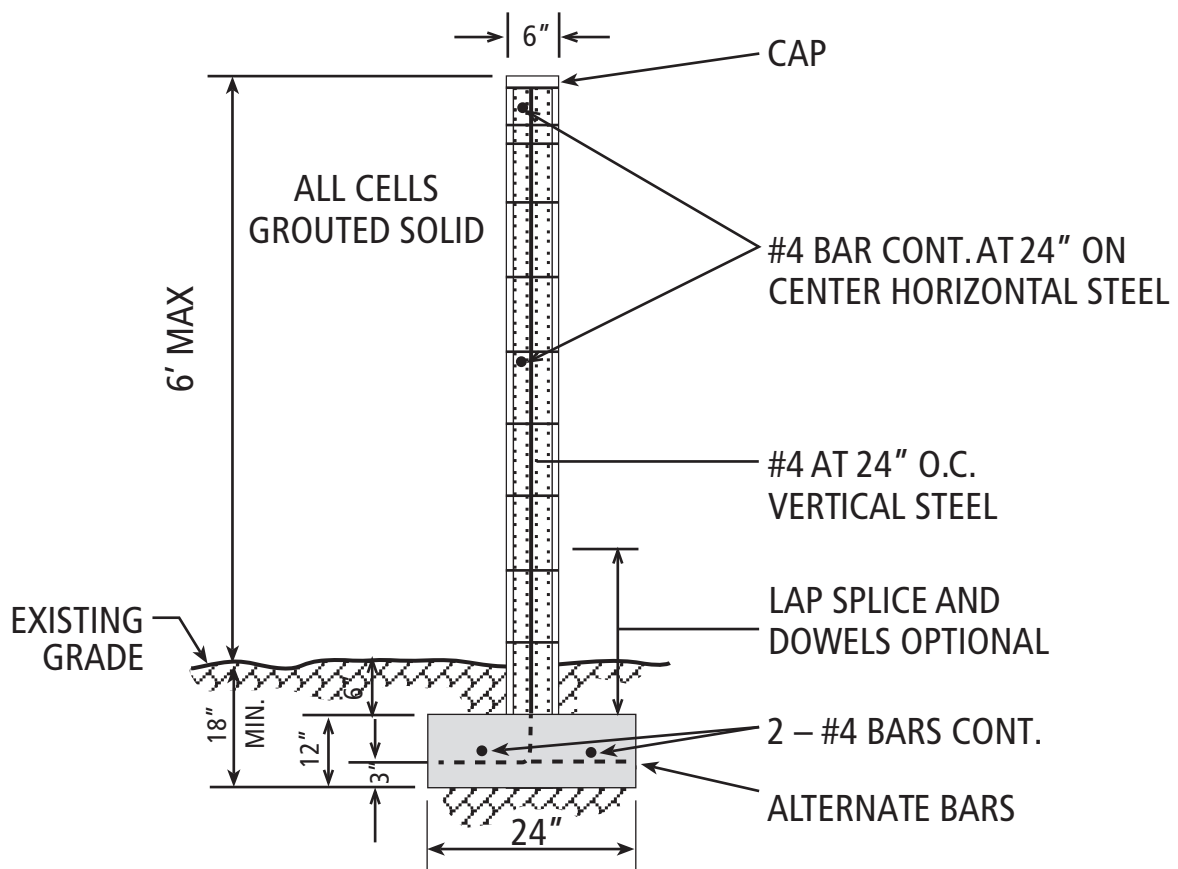

THIS HANDOUT IS NOT INTENDED TO TAKE THE PLACE OF ANY LAWS OR REGULATIONS

**BLOCK WALL STANDARD
(ALTERNATE)**

MUST BE BUILT EXACTLY TO THESE SPECIFICATIONS

Specifications:

1. Footings should be level, or if ground slopes, use step footings. Each step should be of a height to fit masonry system. All excavations shall be extended into firm soil and shall be clean and contain no loose earth or foreign matter.
2. Minimum soil bearing to be 1000 psf
3. For footings and foundations, use concrete with a minimum strength of 2500 psi @ 28 days
4. Grout ASTM C476
5. Mortar mix: Type S $f'_m=1500$ psi
6. Lap vertical steel 40 bar diameters. (24" minimum) $f_s=20,000$ psi
7. Concrete masonry units: ASTM C90 Concrete Block, Grade A
8. 4 ft max. lift subject to building inspector verification
9. Walls cannot be reconstructed or newly constructed on property lines

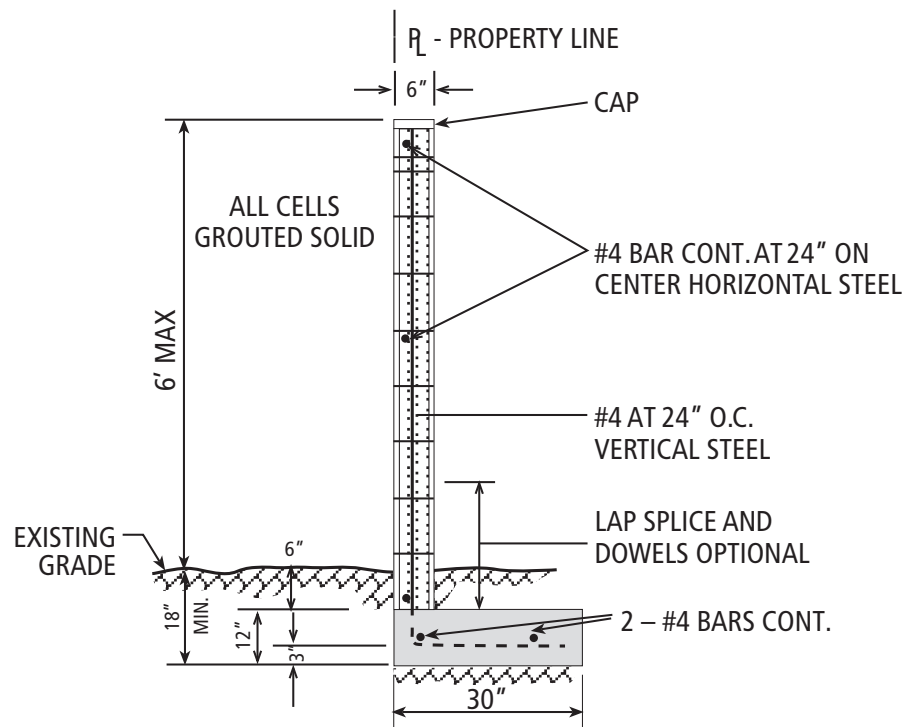

HOURS: Monday, Tuesday, Wednesday and Friday, 7:30 a.m. to 5:00 p.m.
Thursday 9:00 a.m. to 5:00 p.m.
City Hall closed alternate Fridays

LOCATION: Ventura City Hall, 501 Poli Street, Room 117

PHONE: (805) 677-3941

MAILING ADDRESS: P.O. Box 99, Ventura, CA 93002-0099

SCE PLANNING: 805-654-7444