

**MUST BE BUILT EXACTLY TO THESE SPECIFICATIONS**

**Specifications:**

1. All workmanship and materials shall conform with the 2022 California Building Code.
2. Footings shall be level, or if ground slopes, use step footings. Each step shall be of a height to fit masonry system. All excavations shall be extended into firm soil and shall be clean and contain no loose earth or foreign matter.
3. Minimum soil bearing shall be 1,500 pounds per square foot.
4. Concrete: ASTM C150, Type II/V,  $f'_c=2,500$  psi minimum compressive strength at 28 days.
5. Reinforcing Steel: ASTM A615, Grade 40 or Grade 60.
6. Reinforcing Steel Laps: 40 bar diameters (24" minimum).
7. Concrete Masonry Units: ASTM C90 Concrete Block, Grade A ( $f'_m=1,500$  psi).
8. Grout: ASTM C476 - 1 part cement to 3 parts sand to 2 parts pea gravel (2,000 psi at 28 days).
9. Mortar: ASTM C270 Type "S" - 1 part cement to 1/2 part lime to 3 parts damp loose sand (1,800 psi at 28 days).
10. Maximum grout lift shall be 4-foot subject to building inspector verification.
11. Walls cannot be reconstructed or newly constructed on property lines.

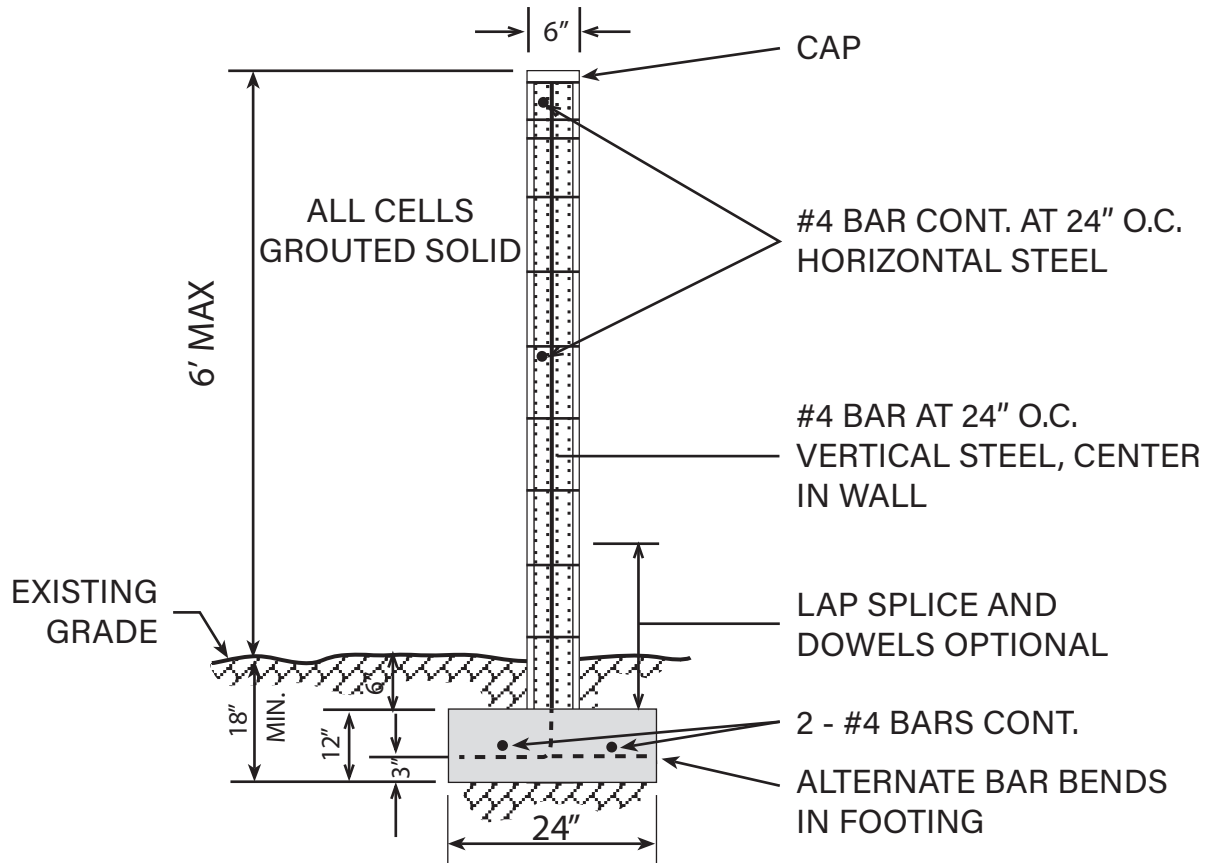

**THIS HANDOUT IS NOT INTENDED TO TAKE THE PLACE OF ANY LAWS OR REGULATIONS**

**BLOCK WALL STANDARD  
(ALTERNATE)**

**MUST BE BUILT EXACTLY TO THESE SPECIFICATIONS**

**Specifications:**

1. All workmanship and materials shall conform with the 2022 California Building Code.
2. Footings shall be level, or if ground slopes, use step footings. Each step shall be of a height to fit masonry system. All excavations shall be extended into firm soil and shall be clean and contain no loose earth or foreign matter.
3. Minimum soil bearing shall be 1,500 pounds per square foot.
4. Concrete: ASTM C150, Type II/V,  $f'c=2,500$  psi minimum compressive strength at 28 days.
5. Reinforcing Steel: ASTM A615, Grade 40 or Grade 60.
6. Reinforcing Steel Laps: 40 bar diameters (24" minimum).
7. Concrete Masonry Units: ASTM C90 Concrete Block, Grade A ( $f'm=1,500$  psi).
8. Grout: ASTM C476 - 1 part cement to 3 parts sand to 2 parts pea gravel (2,000 psi at 28 days).
9. Mortar: ASTM C270 Type "S" - 1 part cement to 1/2 part lime to 3 parts damp loose sand (1,800 psi at 28 days).
10. Maximum grout lift shall be 4-foot subject to building inspector verification.
11. Walls cannot be reconstructed or newly constructed on property lines.

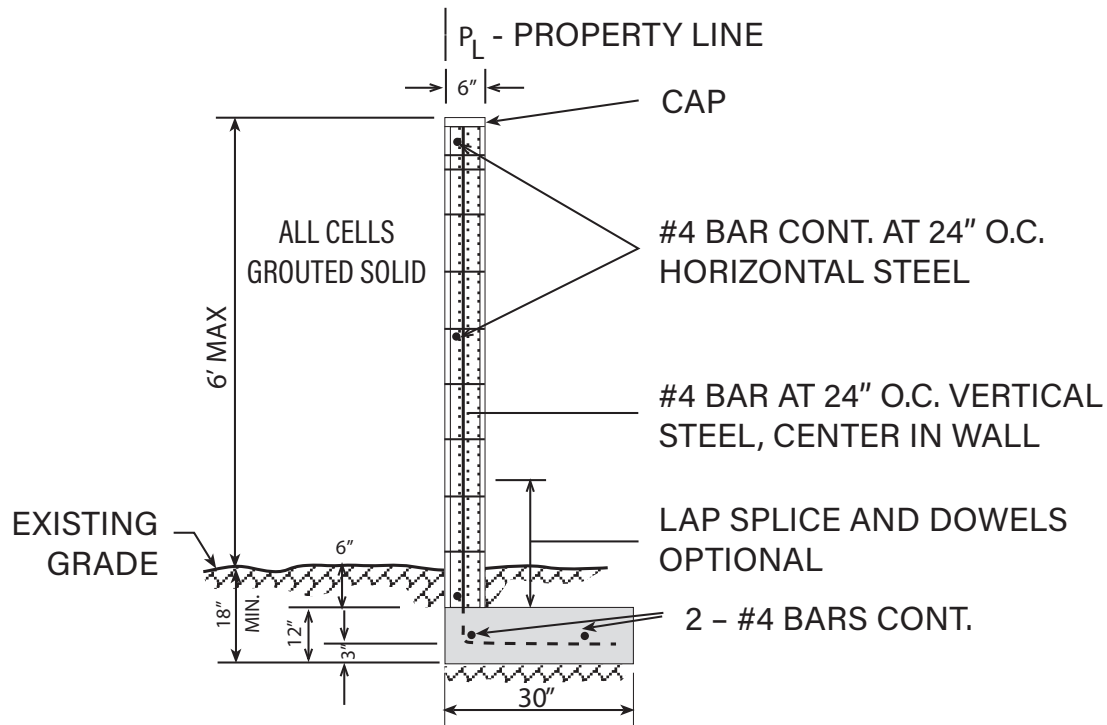

HOURS: Monday, Tuesday, Wednesday and Friday, 7:30 am to 5:00 pm  
Thursday 9:00 am to 5:00 pm • City Hall closed alternate Fridays

LOCATION & MAILING ADDRESS: Ventura City Hall, 501 Poli Street, Room 117, Ventura CA 93001

PHONE: 805-677-3941

SCE PLANNING: 805-654-7444