

MUST BE BUILT EXACTLY TO THESE SPECIFICATIONS

SLOPING GRADE

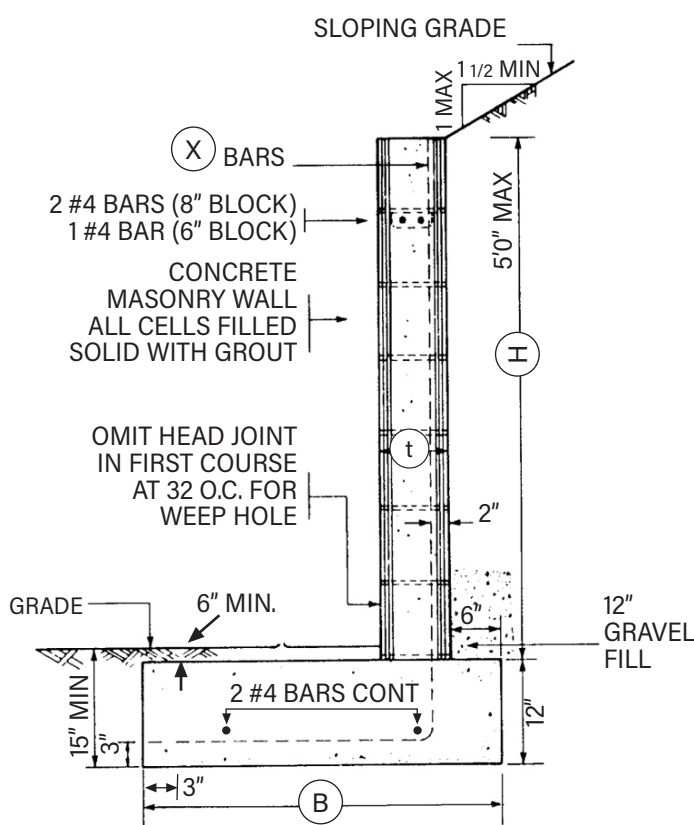

POUR FOOTING AGAINST UNDISTURBED NATURAL SOIL

H	t	B	X BARS
3'	6"	2'-3"	#4 @ 32" O.C.
4'	8"	3'-0"	#4 @ 24" O.C.
5'	8"	3'-6"	#5 @ 16" O.C.

Design for Sloping Grade Above Wall

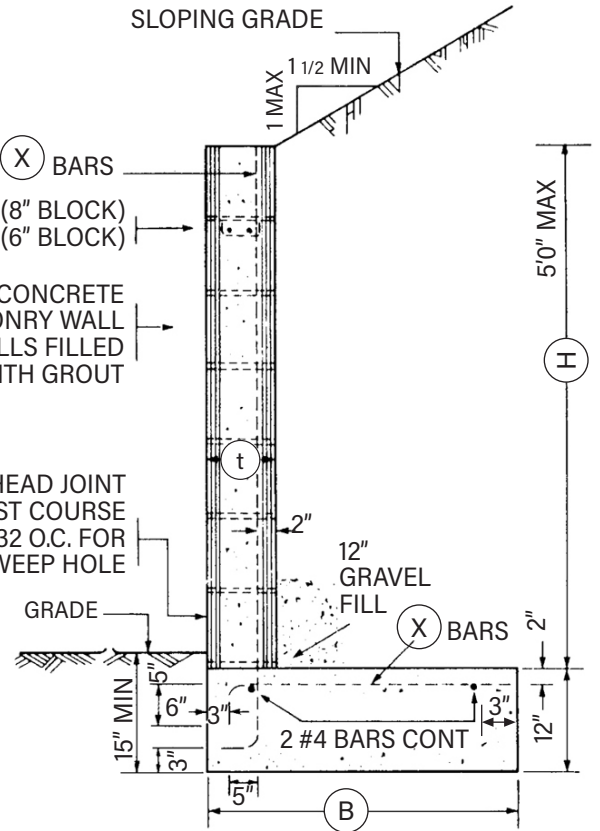

POUR FOOTING AGAINST UNDISTURBED NATURAL SOIL

H	t	B	X BARS
3'	6"	2'-9"	#4 @ 32" O.C.
4'	8"	3'-6"	#4 @ 24" O.C.
5'	8"	4'-0"	#5 @ 16" O.C.

Design for Sloping Grade Above Wall

PERMIT REQUIRED FOR WALLS REFORMING 3 FT.

GENERAL NOTES:

- All workmanship and materials shall conform with the 2022 California Building Code.
- Concrete: ASTM C150, Type II/V, $f'c=2,500$ psi minimum compressive strength at 28 days.
- Reinforcing Steel: ASTM A615, Grade 40 or Grade 60.
- Reinforcing Steel Laps: 40 bar diameters (24" minimum).
- Concrete Masonry Units: ASTM C90 Concrete Block, Grade A ($f'm=1,500$ psi).
- Grout: ASTM C476 - 1 part cement to 3 parts sand to 2 parts pea gravel (2,000 psi at 28 days).
- Mortar: ASTM C270 Type "S" - 1 part cement to 1/2 part lime to 3 parts damp loose sand (1,800 psi at 28 days).
- Soil: Minimum soil bearing shall be 1,500 pounds per square foot.
- Backfill: Cohesionless soil.
- No surcharge on wall. Consult a professional Civil or Structural Engineer for design of retaining walls having:
 - a height greater than 5 feet and/or
 - any surcharge. (Vehicle loading, adjacent footings, etc.)
- 4 ft max. lift subject to building inspector verification
- Walls cannot be reconstructed or newly constructed on property lines

THIS HANDOUT IS NOT INTENDED TO TAKE THE PLACE OF ANY LAWS OR REGULATIONS

MUST BE BUILT EXACTLY TO THESE SPECIFICATIONS

LEVEL GRADE

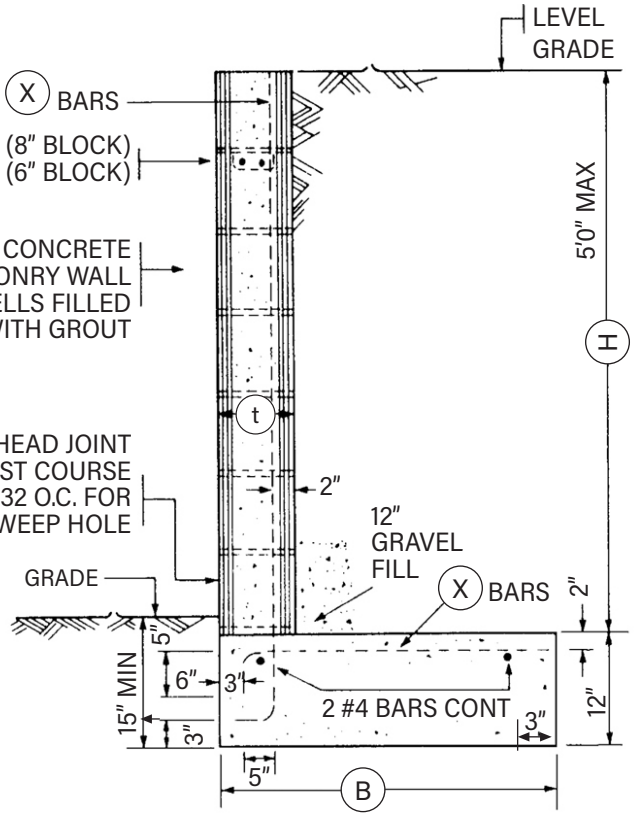
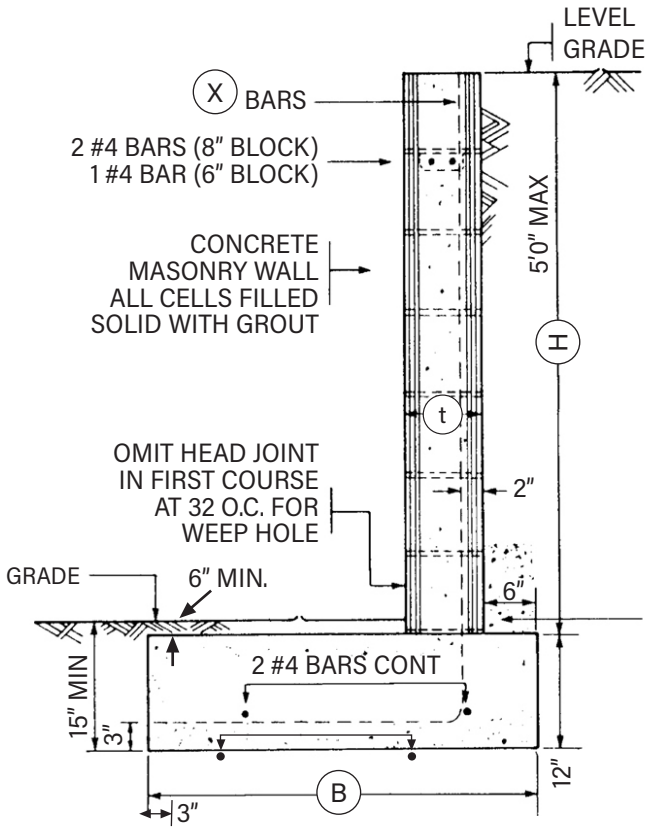

POUR FOOTING AGAINST UNDISTURBED NATURAL SOIL

H	t	B	X BARS
3'	6"	1'-9"	#4 @ 32" O.C.
4'	8"	2'-3"	#4 @ 24" O.C.
5'	8"	2'-9"	#5 @ 24" O.C.

Design for Level Grade Above Wall

POUR FOOTING AGAINST UNDISTURBED NATURAL SOIL

H	t	B	X BARS
3'	6"	1'-10"	#4 @ 32" O.C.
4'	8"	2'-6"	#4 @ 24" O.C.
5'	8"	3'-0"	#5 @ 24" O.C.

Design for Level Grade Above Wall

GENERAL NOTES:

- All workmanship and materials shall conform with the 2022 California Building Code.
- Concrete: ASTM C150, Type II/V, $f'c=2,500$ psi minimum compressive strength at 28 days.
- Reinforcing Steel: ASTM A615, Grade 40 or Grade 60.
- Reinforcing Steel Laps: 40 bar diameters (24" minimum).
- Concrete Masonry Units: ASTM C90 Concrete Block, Grade A ($f'm=1,500$ psi).
- Grout: ASTM C476 - 1 part cement to 3 parts sand to 2 parts pea gravel (2,000 psi at 28 days).
- Mortar: ASTM C270 Type "S" - 1 part cement to 1/2 part lime to 3 parts damp loose sand (1,800 psi at 28 days).
- Soil: Minimum soil bearing shall be 1,500 pounds per square foot.
- Backfill: Cohesionless soil.
- No surcharge on wall. Consult a professional Civil or Structural Engineer for design of retaining walls having:
 - a height greater than 5 feet and/or
 - any surcharge. (Vehicle loading, adjacent footings, etc.)
- 4 ft max. lift subject to building inspector verification
- Walls cannot be reconstructed or newly constructed on property lines

HOURS:

Monday, Tuesday, Wednesday and Friday, 7:30 am to 5:00 pm
Thursday 9:00 am to 5:30 pm • City Hall closed alternate Fridays

LOCATION & MAILING ADDRESS:

Ventura City Hall, 501 Poli Street, Room 117, Ventura CA 93001

PHONE:

805-654-7869