

\* CURB FACE, 6" UNLESS OTHERWISE NOTED ON THE PLANS.

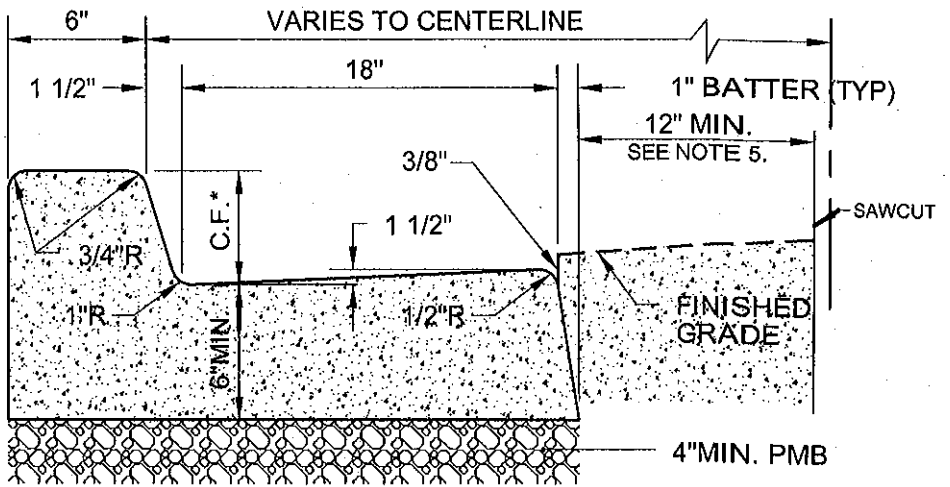

### TYPE "A" CURB AND GUTTER

ALL CURB AND GUTTER SHALL BE TYPE "A" UNLESS OTHERWISE APPROVED BY THE CITY ENGINEER.

\* CURB FACE, 8" UNLESS OTHERWISE NOTED ON THE PLANS.

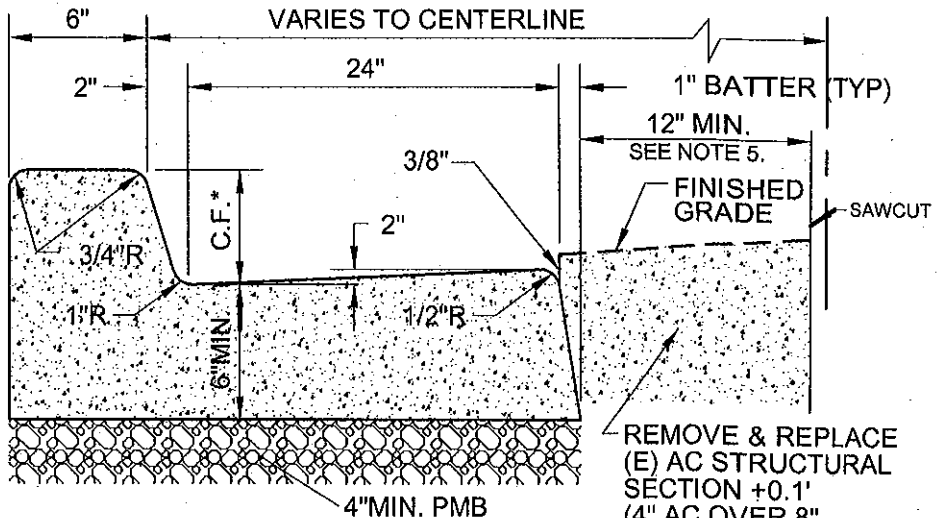

### TYPE "B" CURB AND GUTTER

REMOVE & REPLACE (E) AC STRUCTURAL SECTION +0.1' (4" AC OVER 8" PMB MIN)

**NOTES:**

1. ALL WORK SHALL BE DONE IN ACCORDANCE WITH THE "STANDARD SPECIFICATIONS FOR PUBLIC WORKS CONSTRUCTION".
2. 4" MINIMUM PMB SHALL BE PLACED UNDER CURB AND GUTTER OR CURB. COMPACT TO 95% RELATIVE DENSITY.
3. THE FACE AND TOP OF THE CURB SHALL BE TROWELLED THEN FINISHED WITH A FINE HAIR BROOM. THE GUTTER SHALL BE TROWELLED SMOOTH ON 4 INCHES NEXT TO THE CURB.
4. CONCRETE SHALL BE 520-C-2500.
5. A MINIMUM OF 12" WIDE AC PAVEMENT REPAIR PATCH IS REQUIRED WHEN CURB AND GUTTER IS PLACED ADJACENT TO EXISTING AC PAVEMENT.

CITY OF SAN BUENAVENTURA

PUBLIC WORKS DEPARTMENT  
ENGINEERING DIVISION

CURB & GUTTER

STD. DET. NO.

107

APPROVED BY: *J.M. Delatorre*  
PRINCIPAL CIVIL ENGINEER

APPROVED BY: *R. R. O.*  
CITY ENGINEER R.C.E. 37084

DATE 2-25-14

SHEET  
1 of 2

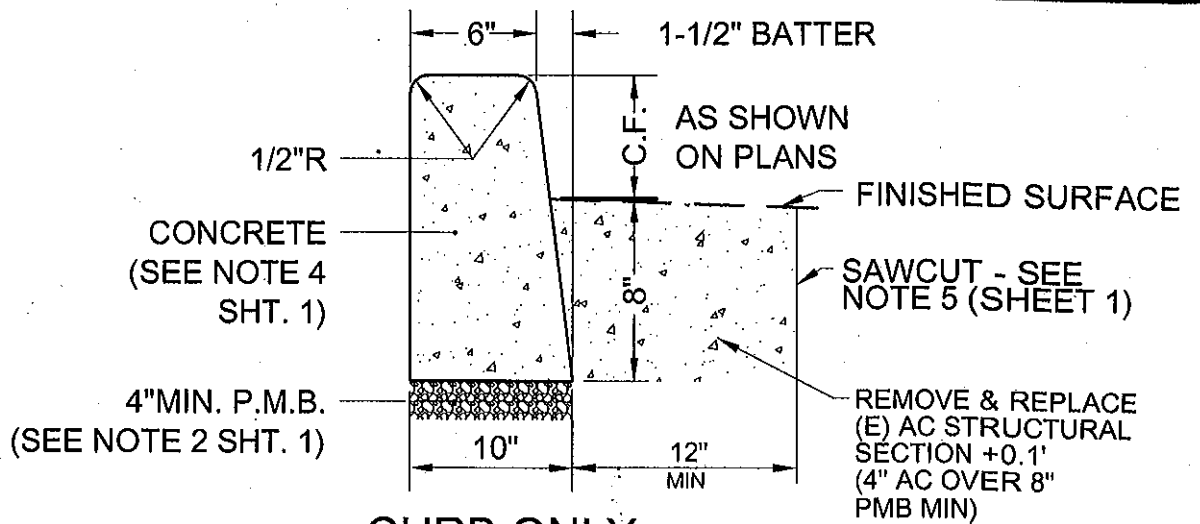

**CURB ONLY**

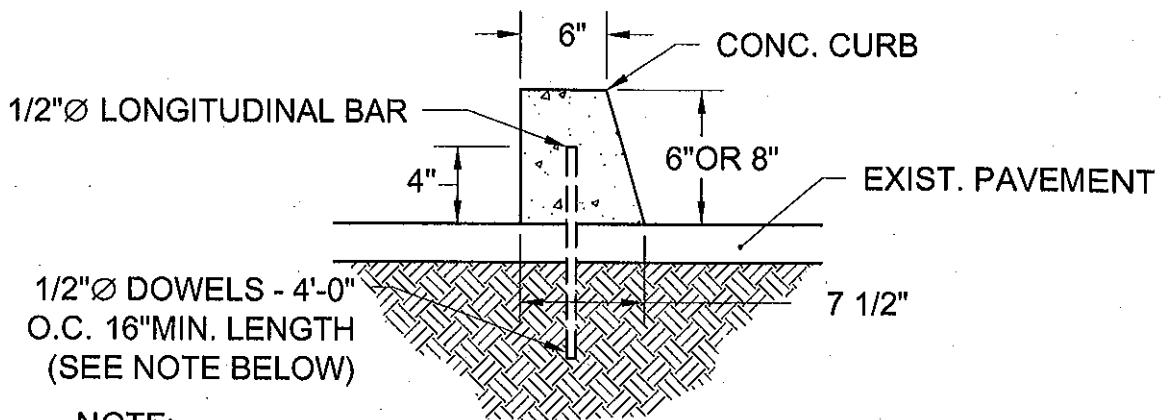

**NOTE:**

1. EXPANSION JOINTS PER CITY STANDARD PLAN 102.
2. WHERE APPROVED BY THE CITY ENGINEER, EPOXY RESIN MAY BE USED IN LIEU OF DOWELING.

**SUPERPOSED CONCRETE CURB**

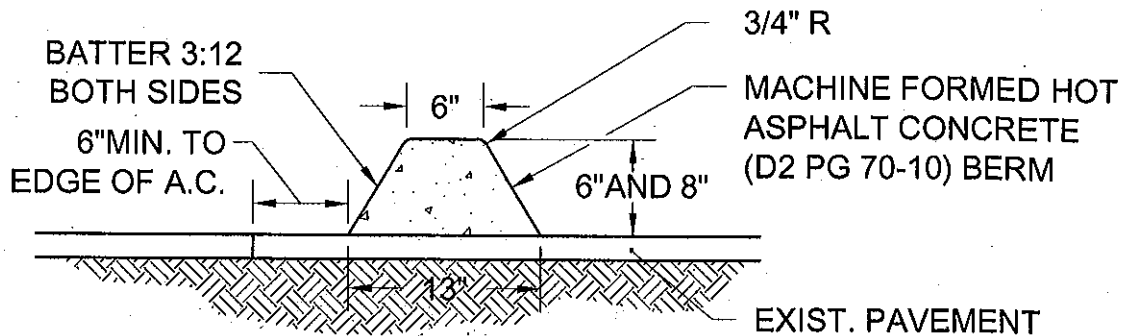

**ASPHALT CONCRETE BERM**

CITY OF SAN BUENAVENTURA

PUBLIC WORKS DEPARTMENT  
 ENGINEERING DIVISION

CURB & GUTTER

STD. DET. NO.

107

APPROVED BY: *J. McDermott*  
 PRINCIPAL CIVIL ENGINEER

APPROVED BY: *[Signature]*  
 CITY ENGINEER R.C.E. 37064

DATE 2-25-14

SHEET  
 2 of 2